

# VME-1050QU

in Sandwich Mounts (UNC Thread) Type 5

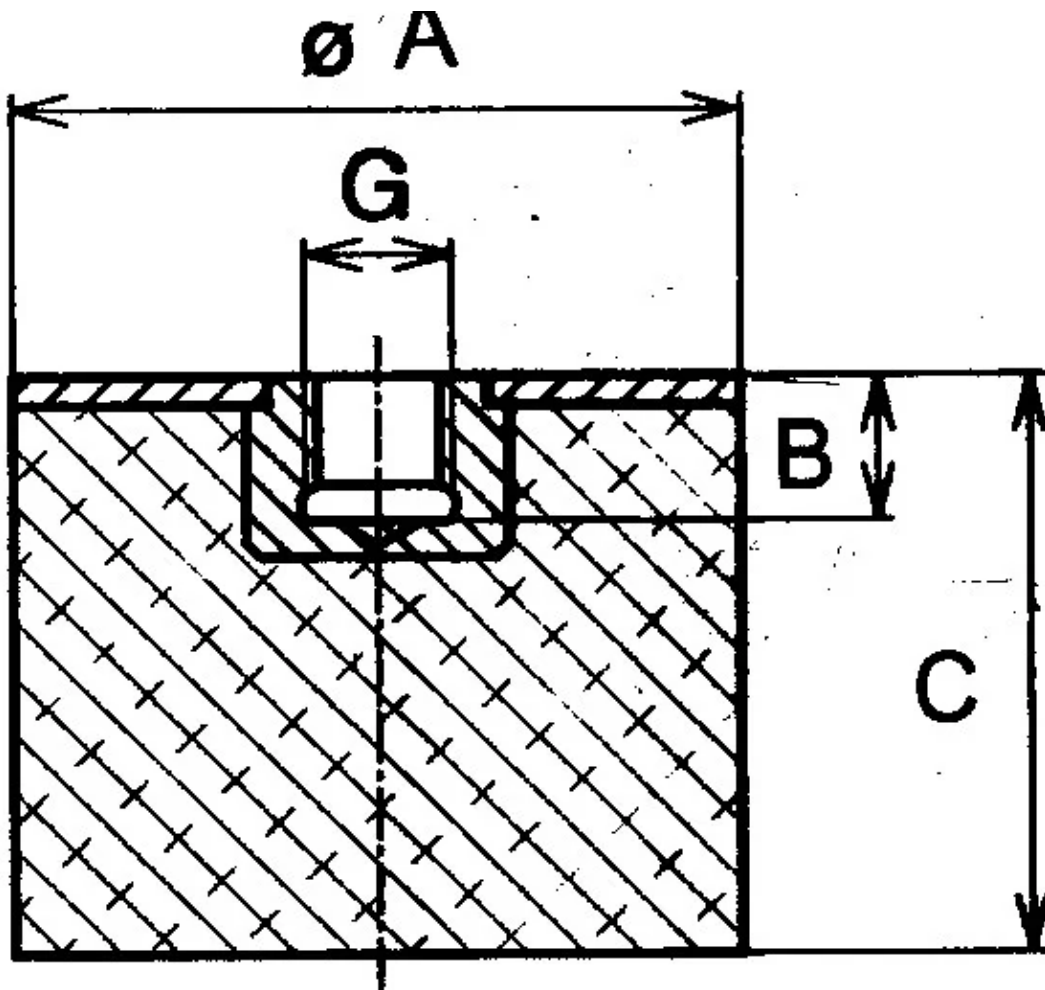



- Economical.
- Compact and lightweight.
- Easy to install.
- Maintenance-free.
- Three size groups: small, medium and large.
- Unitized construction.

RPM Mechanical's sandwich mounts are designed to be a simple and effective way to absorb energy, the resulting effect isolates and protects your equipment from damaging impact forces.

This product type can also be used as machine supports when securing your unit to a base is not required or when the base is not strong enough. Giving you a simple and effective product to isolate your equipment.

Other materials are available on request, contact our sales staff for more information.

COMPRESSION STATIC LOAD (LBS)	2665
COMPRESSION STATIC LOAD (N)	11859
COMPRESSION - SPRING RATE KC (LBS/IN)	1891
COMPRESSION - SPRING RATE KC (N/MM)	1891
A (IN)	4
B (IN)	0.63
C (IN)	2
THREAD SIZE	5/8-11 UNC
DUROMETER	68
ELASTOMER	Natural Rubber
THREAD TYPE	Standard UNC
PRODUCT TYPE	
MANUFACTURER	RPM Mechanical Inc
TYPE	5
GRADE PER SAE J429	