

# SSB33-1000-2 Two-Piece Mounts Ssb Series



Item # SSB33-1000-2 Two-Piece Mounts Ssb Series  
 Manufacturer: Lord Corporation

## Specifications

A (in)	3.24
Axial Static Spring Rate (lbs/in)	15200
Axial Static Spring Rate (Metric)	2650
B (in)	3.21
C (in)	0.81
D (in)	0.125
E (in)	1.81
F (in)	1.84
I (in)	0.765
I (mm)	19.4
K (in)	2.06
K (mm)	52.3
Manufacturer	Parker LORD

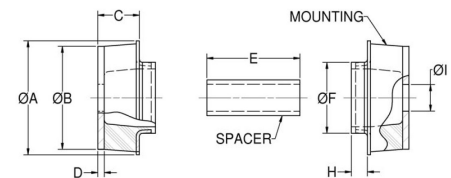

Two-Piece Mounts are designed for applications involving severe dynamic forces in the static load direction, as well as the rebound direction. Travel is limited in both directions by rubber in compression which provides snubbing. These mounts are designed to support engines, cabs and accessory units, accommodate frame racking and twisting while isolating vibration and absorbing shock. Typical applications for Two-Piece Mounts include on-highway, off-highway vehicles,

[Request for Quote](#)
[Contact Us](#)

**USA**  
 4392 Broadway  
 Depew, NY 14043

**Canada**  
 2290 Industrial Street  
 Burlington, Ontario  
 L7P 1A1

888.842.5668

905.335.5523

info@rpmrubberparts.com



# SSB33-1000-2 Two-Piece Mounts Ssb Series



Item # SSB33-1000-2 Two-Piece Mounts Ssb Series  
 Manufacturer: Lord Corporation

## Specifications (Continued)

Material	Low Carbon Steel
Max Axial Static Load at Deflection (lbs)	625 at 0.045
Max Axial Static Load Rating at Deflection (lbs/in)	625 at 0.045
MOG PN	J-7401-27
Radial Static Spring Rate (lbs/in)	2220
Radial Static Spring Rate (Metric)	2220
Recommended Bolt Grade or Class (SAE J1199)	10.9
Recommended Bolt Grade or Class (SAE J429)	8
Recommended Bolt Size (in)	3/4
SD (in)	1.87
SD (mm)	47.6
Series	SSB
Spacer PN	Y-30100-7-1

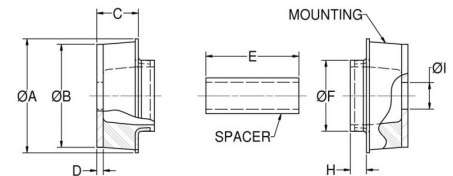

Two-Piece Mounts are designed for applications involving severe dynamic forces in the static load direction, as well as the rebound direction. Travel is limited in both directions by rubber in compression which provides snubbing. These mounts are designed to support engines, cabs and accessory units, accommodate frame racking and twisting while isolating vibration and absorbing shock. Typical applications for Two-Piece Mounts include on-highway, off-highway vehicles,



[Request for Quote](#)

[Contact Us](#)

**USA**  
 4392 Broadway  
 Depew, NY 14043

**Canada**  
 2290 Industrial Street  
 Burlington, Ontario  
 L7P 1A1

888.842.5668  
 905.335.5523  
[info@rpmrubberparts.com](mailto:info@rpmrubberparts.com)



# SSB33-1000-2 Two-Piece Mounts Ssb Series



Item # SSB33-1000-2 Two-Piece Mounts Ssb Series  
 Manufacturer: Lord Corporation

## Specifications (Continued)

T (in)	0.625
T (mm)	15.9
Types	Kit

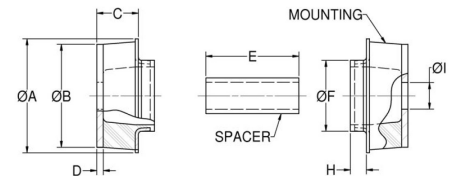

Two-Piece Mounts are designed for applications involving severe dynamic forces in the static load direction, as well as the rebound direction. Travel is limited in both directions by rubber in compression which provides snubbing. These mounts are designed to support engines, cabs and accessory units, accommodate frame racking and twisting while isolating vibration and absorbing shock. Typical applications for Two-Piece Mounts include on-highway, off-highway vehicles,



[Request for Quote](#)

[Contact Us](#)

**USA**  
 4392 Broadway  
 Depew, NY 14043

**Canada**  
 2290 Industrial Street  
 Burlington, Ontario  
 L7P 1A1

888.842.5668  
 905.335.5523  
[info@rpmrubberparts.com](mailto:info@rpmrubberparts.com)

