

SSB33-1000-4 Two-Piece Mounts Ssb Series



Item # SSB33-1000-4 Two-Piece Mounts Ssb Series
 Manufacturer: Lord Corporation

Specifications

A (in)	3.24
Axial Static Spring Rate (lbs/in)	37500
Axial Static Spring Rate (Metric)	6566
B (in)	3.21
C (in)	0.81
D (in)	0.125
E (in)	1.81
F (in)	1.84
I (in)	0.765
I (mm)	19.4
K (in)	2.06
K (mm)	52.3
Manufacturer	Parker LORD

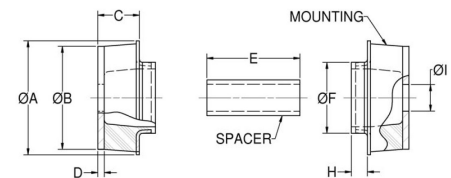

Two-Piece Mounts are designed for applications involving severe dynamic forces in the static load direction, as well as the rebound direction. Travel is limited in both directions by rubber in compression which provides snubbing. These mounts are designed to support engines, cabs and accessory units, accommodate frame racking and twisting while isolating vibration and absorbing shock. Typical applications for Two-Piece Mounts include on-highway, off-highway vehicles,

[Request for Quote](#)
[Contact Us](#)

USA
 4392 Broadway
 Depew, NY 14043

Canada
 2290 Industrial Street
 Burlington, Ontario
 L7P 1A1

☎ 888.842.5668

☎ 905.335.5523

✉ info@rpmrubberparts.com



SSB33-1000-4 Two-Piece Mounts Ssb Series



Item # SSB33-1000-4 Two-Piece Mounts Ssb Series
 Manufacturer: Lord Corporation

Specifications (Continued)

Material	Low Carbon Steel
Max Axial Static Load at Deflection (lbs)	1125 at 0.03
Max Axial Static Load Rating at Deflection (lbs/in)	1125 at 0.03
MOG PN	SSB33-1001-4
Radial Static Spring Rate (lbs/in)	3890
Radial Static Spring Rate (Metric)	3890
Recommended Bolt Grade or Class (SAE J1199)	10.9
Recommended Bolt Grade or Class (SAE J429)	8
Recommended Bolt Size (in)	3/4
SD (in)	1.87
SD (mm)	47.6
Series	Armored Series SSB KIT
Spacer PN	Y-32190-1-1

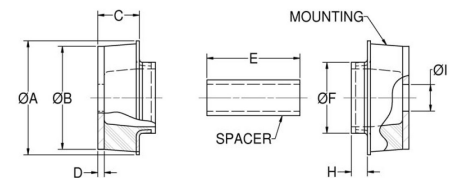

Two-Piece Mounts are designed for applications involving severe dynamic forces in the static load direction, as well as the rebound direction. Travel is limited in both directions by rubber in compression which provides snubbing. These mounts are designed to support engines, cabs and accessory units, accommodate frame racking and twisting while isolating vibration and absorbing shock. Typical applications for Two-Piece Mounts include on-highway, off-highway vehicles,

[Request for Quote](#)
[Contact Us](#)

USA
 4392 Broadway
 Depew, NY 14043

Canada
 2290 Industrial Street
 Burlington, Ontario
 L7P 1A1

888.842.5668

905.335.5523

info@rpmrubberparts.com



SSB33-1000-4 Two-Piece Mounts Ssb Series



Item # SSB33-1000-4 Two-Piece Mounts Ssb Series
 Manufacturer: Lord Corporation

Specifications (Continued)

T (in)	0.625
T (mm)	15.9
Types	Kit

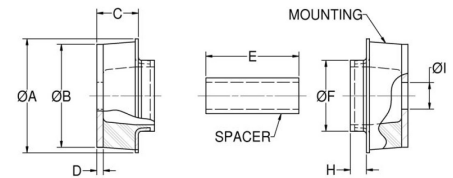

Two-Piece Mounts are designed for applications involving severe dynamic forces in the static load direction, as well as the rebound direction. Travel is limited in both directions by rubber in compression which provides snubbing. These mounts are designed to support engines, cabs and accessory units, accommodate frame racking and twisting while isolating vibration and absorbing shock. Typical applications for Two-Piece Mounts include on-highway, off-highway vehicles,



[Request for Quote](#)

[Contact Us](#)

USA
 4392 Broadway
 Depew, NY 14043

Canada
 2290 Industrial Street
 Burlington, Ontario
 L7P 1A1

888.842.5668
 905.335.5523
info@rpmrubberparts.com

